

Click a room to see location/level

Room Name	Level	Ref
Abbey Road	4	F6
Alchemy	3	E7
Alley	5	J11
Arthaus	1	J10
Atomic/Fuze	4	E7
Banksia	3	C7
Basement	5	L6
The Belltower	6	L7
Biotarium	3	D7
Bitter Pea	5	K7
Boiler Room	2	E7
Business Manager	5	J5
The Canopy	3	C8
Castlerock	4	F9
Cerebellum	3	E8
Charles Bean Oval	5	H1
Clocktower	3	G9
Cobblestone	3	J9
The Collective/PE, VA, TAS Staff	6	I5
Counsellor	5	J5
COLA	2	K10
The Cove	2	K10
Crossroads	5	I10
Dada	1	I10
Dark Room	1	J10
Designz	2	E8
Digital Factory	2	E8
Dragonstone	3	F9
Engine Room	5	K6
Facilities Manager	5	J5
Factory	4	I8
Fernery/Dance Studio	5	H2
Forge	4	I8
Fusion	5	L8
Galleria	1	I10
The Galley	4	H8
Glasshouse	3	F10

Room Name	Level	Ref
Globe	5	G10
Greenhalgh Theatre	5	I7
Greenroom	4	H6
Ground Control/First Aid	4	H8
The Grove	4	C7
Gym	4	D2
Harajuku	5	I8
The Hatchery	6	J5
The Hive	6	K6
The Hollow	3	J8
The Huddle	6	J5
Ideate	3	I7
Interchange/SSO	4	F8
Interview Room/Parent Interview	5	D5
Invention	4	E8
IT Hub	5	J5
Iterate	3	I8
Junction	5	I11
K-2 Hub	2	G9
The Keep	5	H10
Ku-ring-gai	5	H10
Labyrinth	4	J6
The Lake	3	J8
Lighthouse	3	I9
The Loft	6	L7
The Lyric	5	G9
Machinarium	2	F6
Matrix	4	J9
Menagerie	4	J9
Metro	5	J10
Mission Control	5	L6
Motown	4	F6
Musaeum/HSIE, Maths, Science Staff	4	C8
Museum	3	J8
Mythvale	4	J8
Olympus	6	H2
The Outlook	2	C8

Room Name	Level	Ref
Paddock	2	I10
Pandemonium	4	I6
The Park	2	J9
Polaroid	2	E8
Pond	2	J10
The Pool	2	G9
Practice Rooms	4	G6
Print Room	5	J5
Public Reception	5	K5
Pump Room	5	H1
Realm	4	D8
The Refuge/K-2 Staff	2	D8
Roasted	5	I9
Science Prep	3	E7
Scriptorium	4	F8
The Shack	2	I11
The Shire	4	G9
Squash Courts	3	E2
Stockpot	5	J9
Student Services	4	H7
Studio 2070	1	B7
Substation/Gateway, Music, SLSO Staff	4	H8
Subway	5	K11
Sweet Pea	1	C8
Tectonica	3	D8
Thirdspace	4	G7
The Toolshed	2	I9
Tranquilidrome	6	H3
Treehouse	6	L7
Tube	5	J11
Underground	5	J10
Utopia/English Staff	5	G9
The Village Store	2	G7
Vortex	4	D7
Wattle	2	C7
The Wheel	2	D7
Wingara/3-6 Staff	3	I11
Workshop	2	E7



Level 6

Room Colours

- Classroom
- Theatres
- Admin Spaces
- Bathrooms / Maker Space
- Lift
- Staircases / Roof spaces
- Hallways / Balcony

Legend

- 400 phone extension
- 1 Car Gate 1-10
- PI Pedestrian Gate 1-21 with intercom
- PI Pedestrian Gate 1-21 NO intercom
- LS Evacuation Path
- red phones
- 1st aid kits

Student Lockers

Rooms on this level

- Cul-de-Sac (Cul-de-Sac)
- Olympus (The Pavillion)
- The Attic (The Avenue)
- The Collective (Cul-de-Sac)
- The Belltower (The Avenue)
- The Eyrie (The Avenue)
- The Hatchery (The Avenue)
- The Huddle (The Avenue)
- The Hive (The Avenue)
- The Loft (The Avenue)
- The Nest (Cul-de-Sac)
- Tranquillidrome (The Pavillion)
- Treehouse (The Avenue)

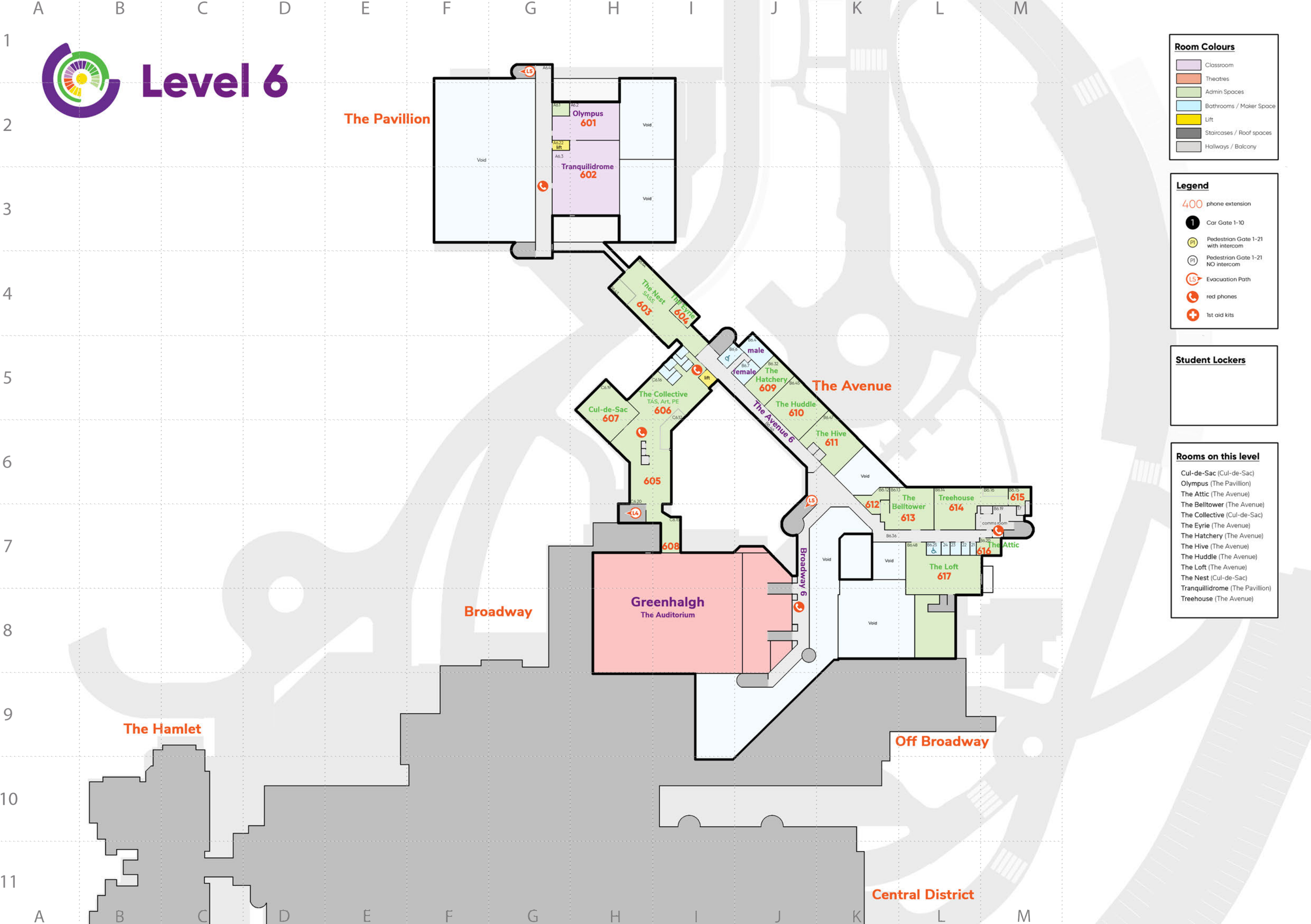

The Pavillion

Olympus 601
Tranquillidrome 602

The Nest 603
The Eyrie 604

Cul-de-Sac 607
The Collective 606

Greenhalgh
The Auditorium

Broadway

The Avenue

The Hatchery 609
The Huddle 610
The Hive 611

The Belltower 612
Treehouse 614
The Attic 615

The Loft 617

The Hamlet

Off Broadway

Central District



Level 4

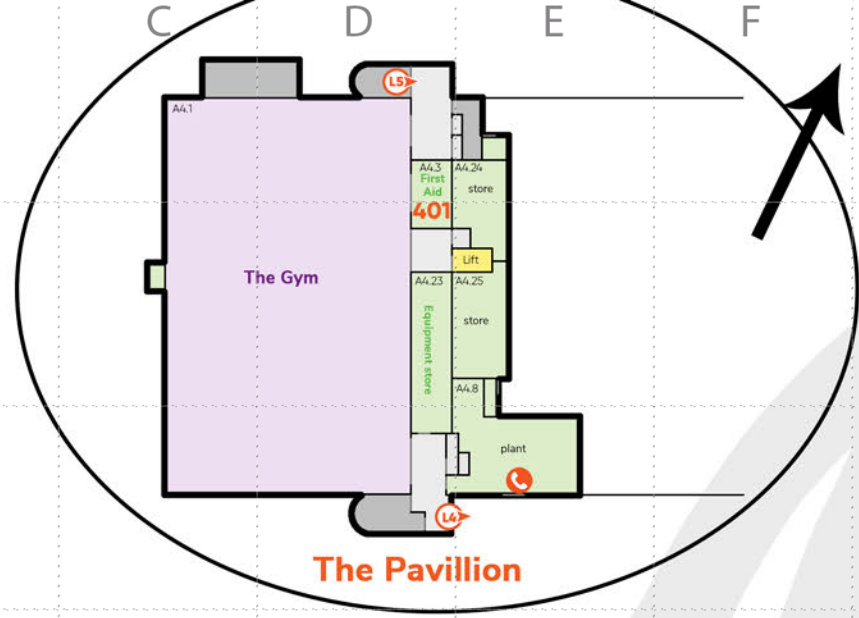

Aurora College



Broadway



The Hamlet

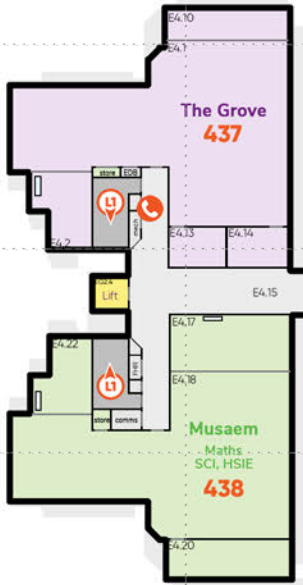

Powerhouse District



The Mill

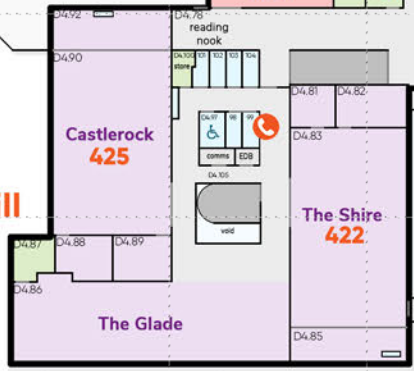

Third Space



Central District



Room Colours

- Classroom
- Theatres
- Admin Spaces
- Bathrooms / Maker Space
- Lift
- Staircases / Roof spaces
- Hallways / Balcony

Legend

- 400 phone extension
- 1 Car Gate 1-10
- P1 Pedestrian Gate 1-21 with intercom
- P1 Pedestrian Gate 1-21 NO intercom
- L5 Evacuation Path
- red phones
- 1st aid kits

Student Lockers

- 1 4.001 - 4.072
- 2 4.073 - 4.132
- 3 4.133 - 4.156
- 4 4.157 - 4.204
- 5 4.205 - 4.270
- 6 4.271 - 4.312
- 7 4.313 - 4.336
- 8 4.337 - 4.372
- 9 4.373 - 4.396
- 10 4.397 - 4.438

Rooms on this level

- Abbey Road (Broadway)
- Atomic (Powerhouse)
- Castlerock (The Mill)
- Creatorium (Central District)
- Fuze (Powerhouse)
- Greenhalgh (Broadway)
- Green Room (Broadway)
- Ground Control (Broadway)
- Gym Store (The Pavillion)
- Imaginarium (Third Space)
- Interchange (Third Space)
- Inventum (Powerhouse)
- Labyrinth (Off Broadway)
- Matrix (Central District)
- Menagerie (Central District)
- Motown (Broadway)
- Musaem (The Hamlet)
- Mythvale (Central District)
- Pandemonium (Off Broadway)
- Realm (Powerhouse)
- Student Services (Broadway)
- Substation (Broadway)
- The Factory (Central District)
- The Forge (Central District)
- The Galley (Broadway)
- The Glade
- The Globe (Broadway)
- The Grove (Broadway)
- The Lyric (Broadway)
- The Scriptorium (Third Space)
- The Shire (The Mill)
- Vortex (Powerhouse)



Level 3

The Pavillion

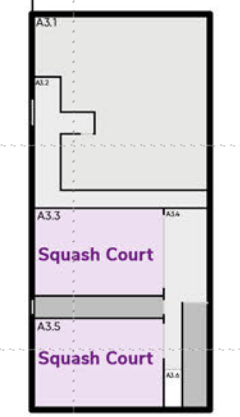

Room Colours

- Classroom
- Theatres
- Admin Spaces
- Bathrooms / Maker Space
- Lift
- Staircases / Roof spaces
- Hallways / Balcony

Legend

- 400 phone extension
- 1 Car Gate 1-10
- P1 Pedestrian Gate 1-21 with intercom
- P1 Pedestrian Gate 1-21 NO Intercom
- L5 Evacuation Path
- red phones
- 1st aid kits

Student Lockers

- 1 3.001 - 3.060
- 2 3.061 - 3.120
- 3 3.121 - 3.174
- 4 3.175 - 3.216
- 5 3.217 - 3.228

Rooms on this level

- Alchemy (Powerhouse)
- Banksia (Hamlet)
- Bioterium (Powerhouse)
- Cerebellum (Powerhouse)
- Clocktower (The Mill)
- Cobblestone (Central District)
- Dragonstone (The Mill)
- Glasshouse (The Mill)
- Ideate (Central District)
- Iterate (Central District)
- Lighthouse (Central District)
- Museum District (Central District)
- Play Pen (Hamlet)
- Prep Science (Powerhouse)
- Sand Pit (Powerhouse)
- Squash Courts (The Pavillion)
- Tectonica (Powerhouse)
- The Canopy (Hamlet)
- The Hollow (Central District)
- The Lake (Central District)
- Wingara (Central District)

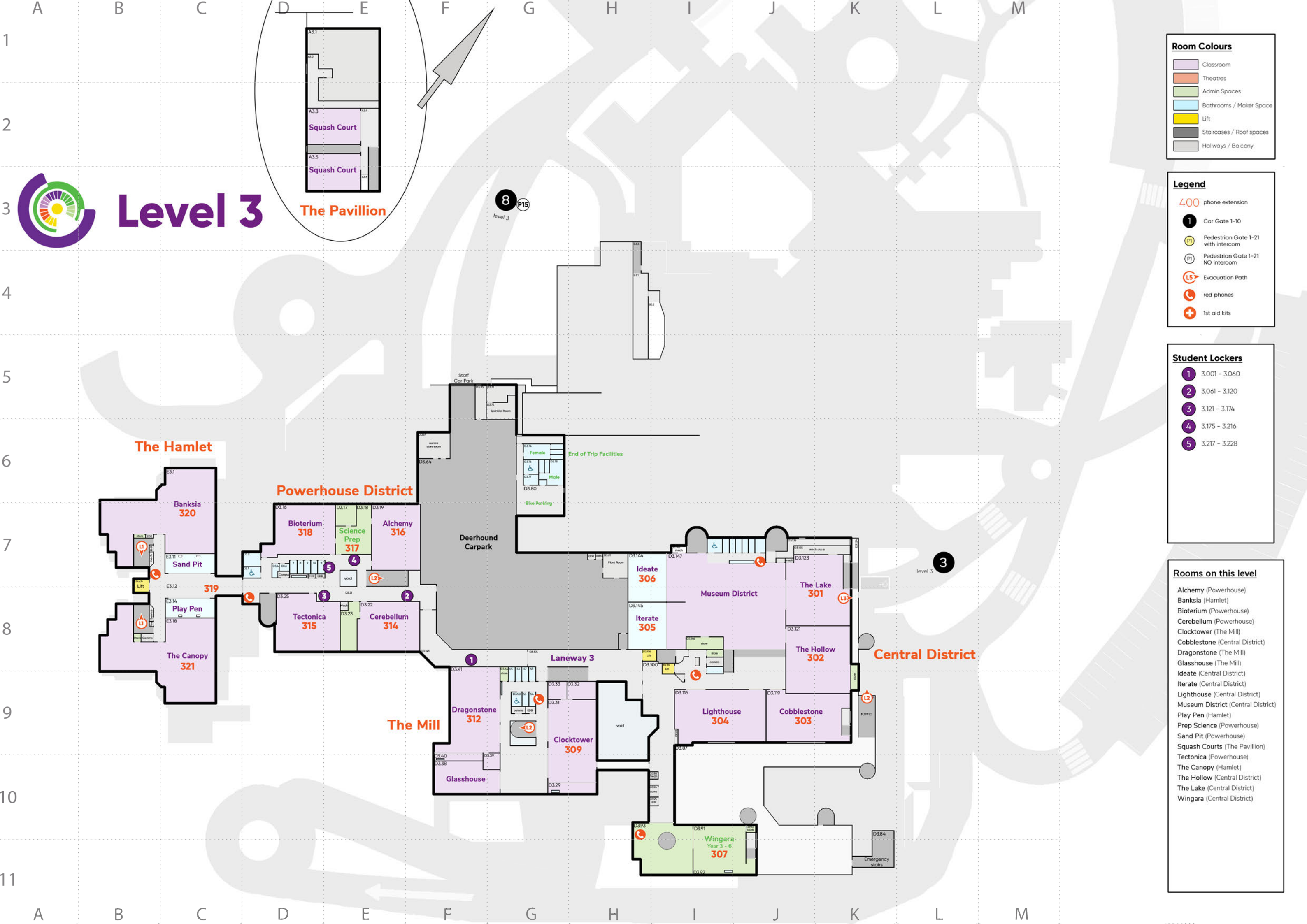
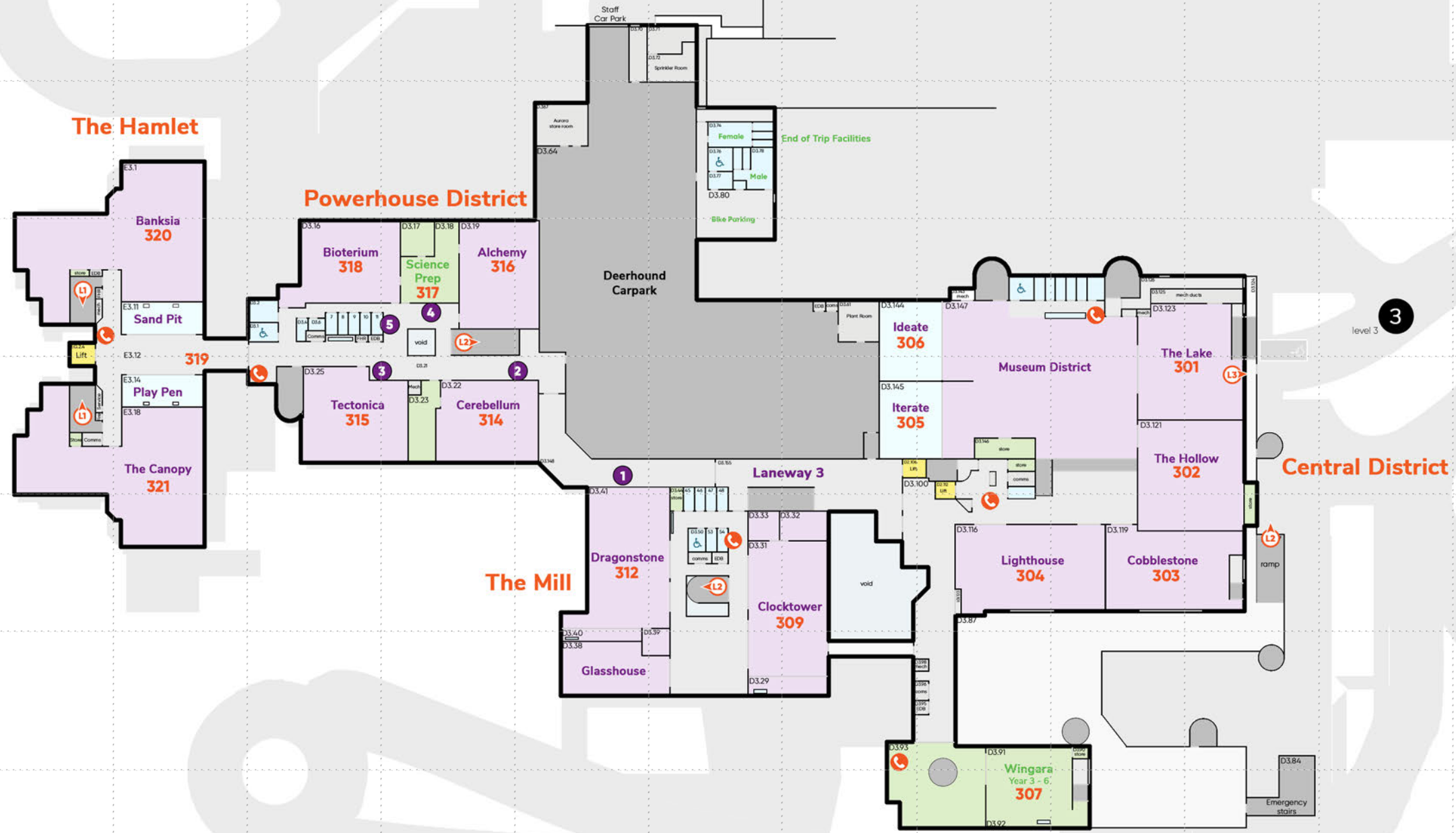



Level 2

Room Colours	
	Classroom
	Theatres
	Admin Spaces
	Bathrooms / Maker Space
	Lift
	Staircases / Roof spaces
	Hallways / Balcony

Legend	
400	phone extension
1	Car Gate 1-10
P1	Pedestrian Gate 1-21 with intercom
P1	Pedestrian Gate 1-21 NO intercom
L5	Evacuation Path
☎	red phones
+	1st aid kits

Student Lockers	
1	2.001 - 2.120
2	2.121 - 2.174

Rooms on this level	
Boiler Room (Powerhouse)	
Catacombes (Broadway)	
Designz (Powerhouse)	
Digital Factory (Powerhouse)	
GA store (Central District)	
Machinarium (Powerhouse)	
Metal Workshop (Powerhouse)	
Paddock (Central District)	
Polaroid (Powerhouse)	
Pond (Central District)	
Shack (Central District)	
The Base (The Mill)	
The Cove (Central District)	
The Outlook (Hamlet)	
The Lair (The Mill)	
The Park (Central District)	
The Playway (Central District)	
The Pool (The Mill)	
The Refuge (Powerhouse)	
The Toolshed (Central District)	
The Yard (Hamlet)	
The Yurt (Hamlet)	
Wattle (Hamlet)	
Wheel (Powerhouse)	
Workshop (Powerhouse)	

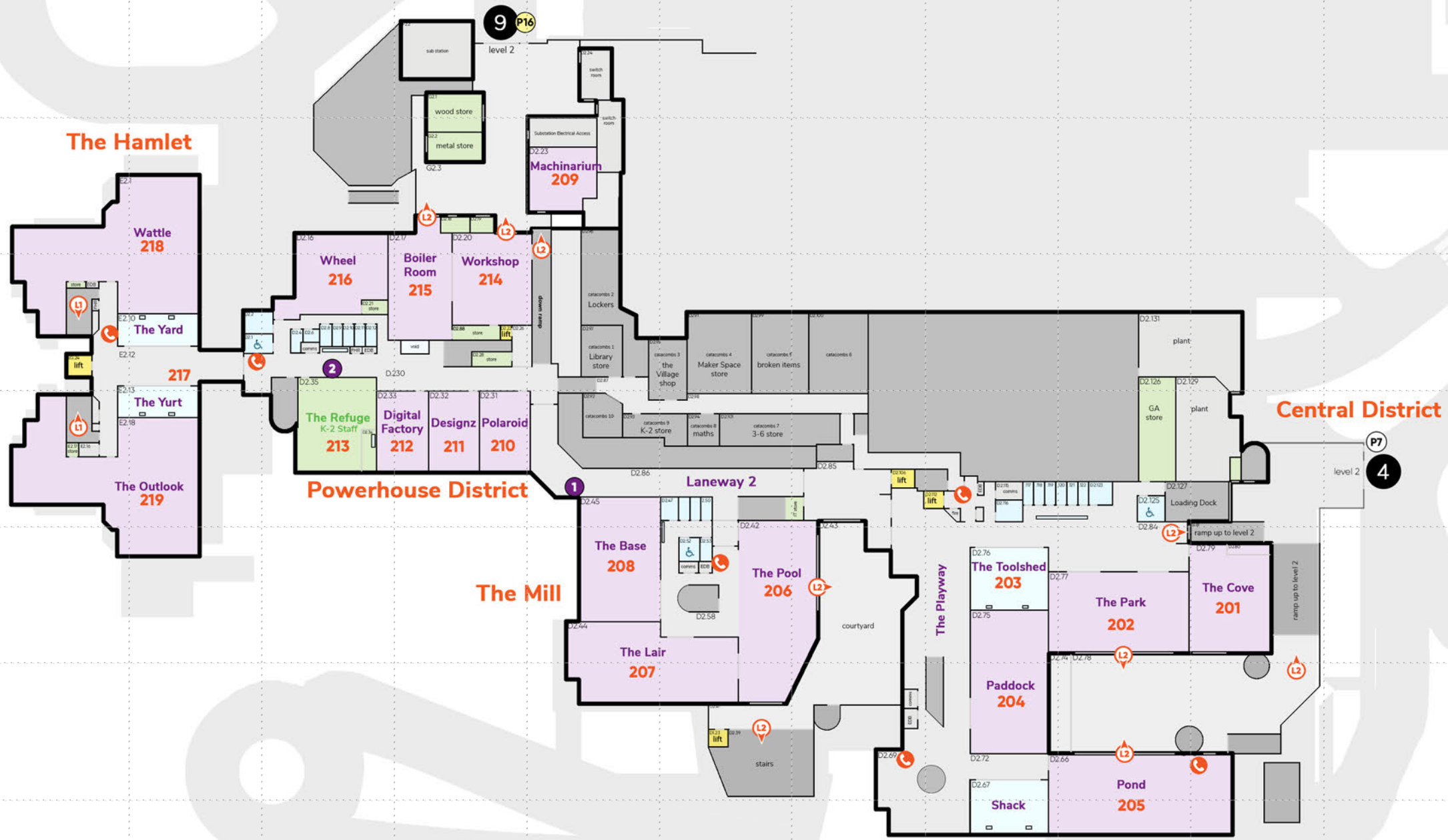

A B C D E F G H I J K L M

11

10

9

8

7

6

5

4

3

2

1



Level 1

Room Colours

- Classroom
- Theatres
- Admin Spaces
- Bathrooms / Maker Space
- Lift
- Staircases / Roof spaces
- Hallways / Balcony

Legend

- 400 phone extension
- 1 Car Gate 1-10
- P1 Pedestrian Gate 1-21 with intercom
- P1 Pedestrian Gate 1-21 NO intercom
- LS Evacuation Path
- ☎ red phones
- + 1st aid kits

Student Lockers

Rooms on this level

- Arthouse (Art District)
- Dada (Art District)
- Dark Room (Art District)
- Galleria (Art District)
- OSHC (Powerhouse)
- Studio 2070 (Hamlet)
- Sweet Pea (Hamlet)

